

Brennan Ayre O'Neill

Estate Agents | Surveyors | Property Managers

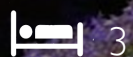

3



1



1



EPC



Council Tax

A

Grasville Road, Birkenhead

£825

19382576



We are delighted to present this three bedroom terrace property to the market. Situated on one of Tranmere's most popular streets, between Victoria Park and Mersey Park, this well-presented home is ready for immediate occupation.

The property features:

- A recently refurbished kitchen
- Modern décor and carpets throughout
- Gas central heating and double glazing for year-round comfort

This is a bright, inviting home that has been thoughtfully finished to create a welcoming living space.

Located centrally in Tranmere, the property is within easy walking distance of shops, regular bus services, and both nearby parks — making it an ideal choice for those seeking convenience and comfort.

Please submit a Rightmove Enquiry form at your earliest availability to secure the best chance of a viewing.

Initial Tenancy: 12 Month  
Council Tax: Band A





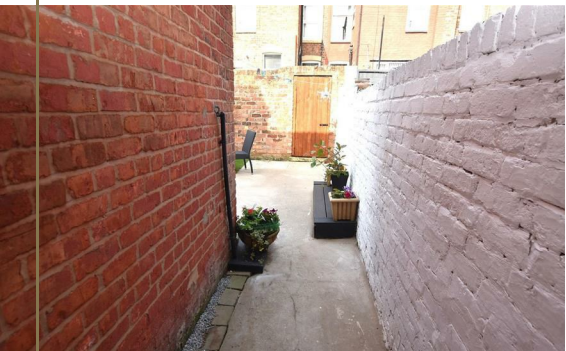

## Floor Plan

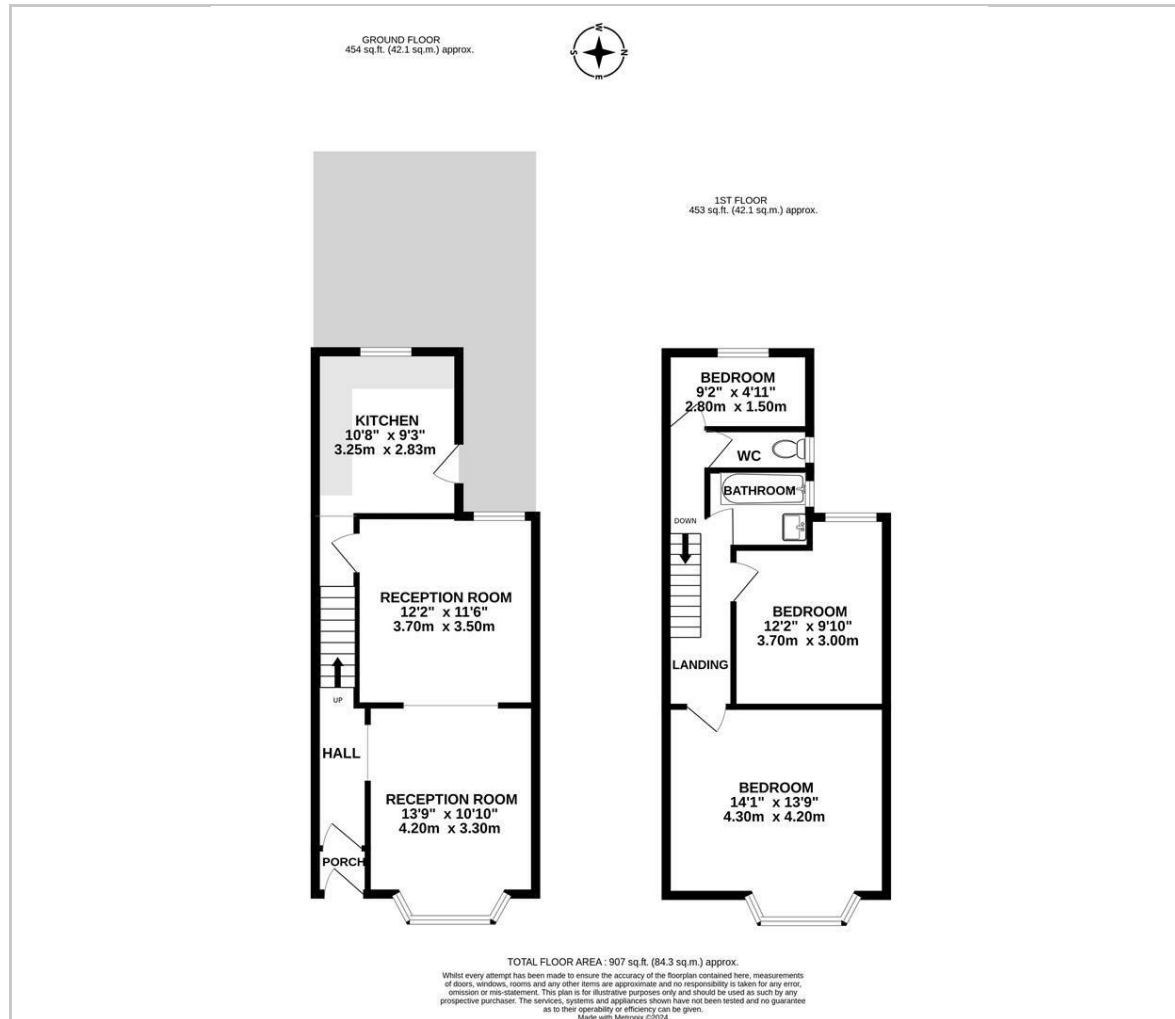

## Viewing

Please contact our Lettings Office on 0151 343 9060  
if you wish to arrange a viewing appointment for this property or require further information.

These particulars, whilst believed to be accurate are set out as a general outline only for guidance and do not constitute any part of an offer or contract. Intending purchasers should not rely on them as statements of representation of fact, but must satisfy themselves by inspection or otherwise as to their accuracy. No person in this firm's employment has the authority to make or give any representation or warranty in respect of the property.

**Brennan Ayre O'Neill**  
Estate Agents | Surveyors | Property Managers

12 High Street, Bromborough, Wirral, CH62 7HA  
Tel: 0151 343 9060  
Email: [lettings@b-a-o.com](mailto:lettings@b-a-o.com)  
[www.b-a-o.com](http://www.b-a-o.com)



19382576